

# ST1100

## Automatic Label Applicator Head

The ST1100 Automatic Label Applicator is a high performance labeling head capable of speeds of up to 1100 linear inches per minute. It comes complete with a direct drive DC stepper motor, powered rewind, a 6.5-inch web width, and a standard 12-inch diameter label roll capacity. Under microprocessor control, the ST1100 is accurate to  $\pm 1/32$  of an inch.



- Heavy duty construction specifically designed for industrial applications.
- Microprocessor controller gives flexible and accurate label placement.
- Stainless steel and anodized aluminum provide protection from corrosive environments.
- Solid drive construction ensures even pressure to the label web resulting in extremely accurate label placement.
- The applicator head can be oriented to any attitude for side, top or bottom placement.
- Handles a full assortment of label shapes and sizes.



# ST1100

## Automatic Label Applicator Head

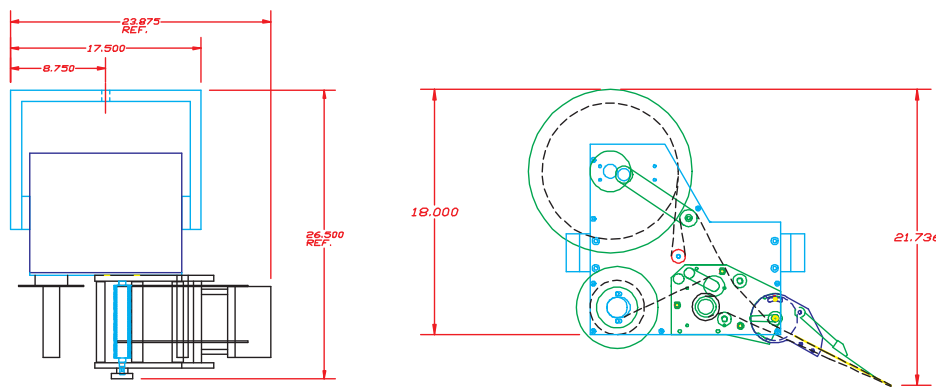

### ST1100 Label Applicator Specifications

<b>Speed</b>	1100 linear inches per minute.
<b>Accuracy</b>	$\pm 1/32$ of an inch with consistent product dimensions
<b>Control Electronics</b>	Microprocessor Controller
<b>Label Size</b>	Minimum: Wipe-on: 1/2" by 1/2"; Wrap: 1" by 1" Maximum: Wipe-on: 6-1/2" by 18.00"; Wrap 6-1/2" by 10.00"
<b>Electrical</b>	115 VAC, 50/60 Hertz, 5 Amps
<b>Product Detection</b>	Photoelectric
<b>Label Capacity</b>	6.5" web width, 12" diameter label roll, 3" core
<b>Options</b>	Low Label Warning Out of Label Warning Web Break Warning Rate Compensation Label/Product Counter Clear Label Sensor Hot Stamp Imprinter Oversize Web Width Imprint Verification

Distributed by:

SOUTHERN  
CALIFORNIA  
PACKAGING  
EQUIPMENT, INC.



4102 W. Valley Blvd Walnut, CA 91789  
909/598-3198 • Fax: 909/598-1363  
[www.scpe.com](http://www.scpe.com)